

Date: 17th July 2018
 Proposed General Elevations
 Drawing scale 1:100 @ A2
 Ground Group Ltd, Wheatley Hall Road Trade & Business Centre, Doncaster

2017-ID-30-PL002b



PLANNING DRAWING

No 6 Whitehouse Way, Epworth, North Lincs
 M: 07917 224361 T: 01427 875012
 E: nwh@sleDesign-architecture.com
 CIAT Chartered Membership No: 015669

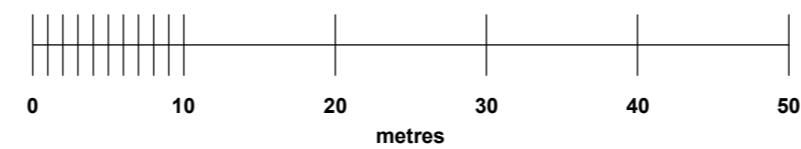

© Crown copyright and database rights 2018 OS 100053143
 Reproduction in whole or part is prohibited without the prior permission of Ordnance Survey.

General Note: The proposed development will comply with the car parking requirements as stated within Doncaster's 'Development and Guidance and Requirements Supplementary Planning Document'.

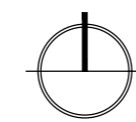

Date: 17th July 2018
 Proposed Site Car Parking Provision Layout
 Drawing scale 1:500@ A2
 Ground Group Ltd, Wheatley Hall Road Trade & Business Centre, Doncaster

2017-ID-30-PL004b

PLANNING DRAWING



No 6 Whitehouse Way, Epworth, North Lincs
 M: 07917 224361 T: 01427 875012
 E: nwh@sleDesign-architecture.com
 CIAT Chartered Membership No: 015669

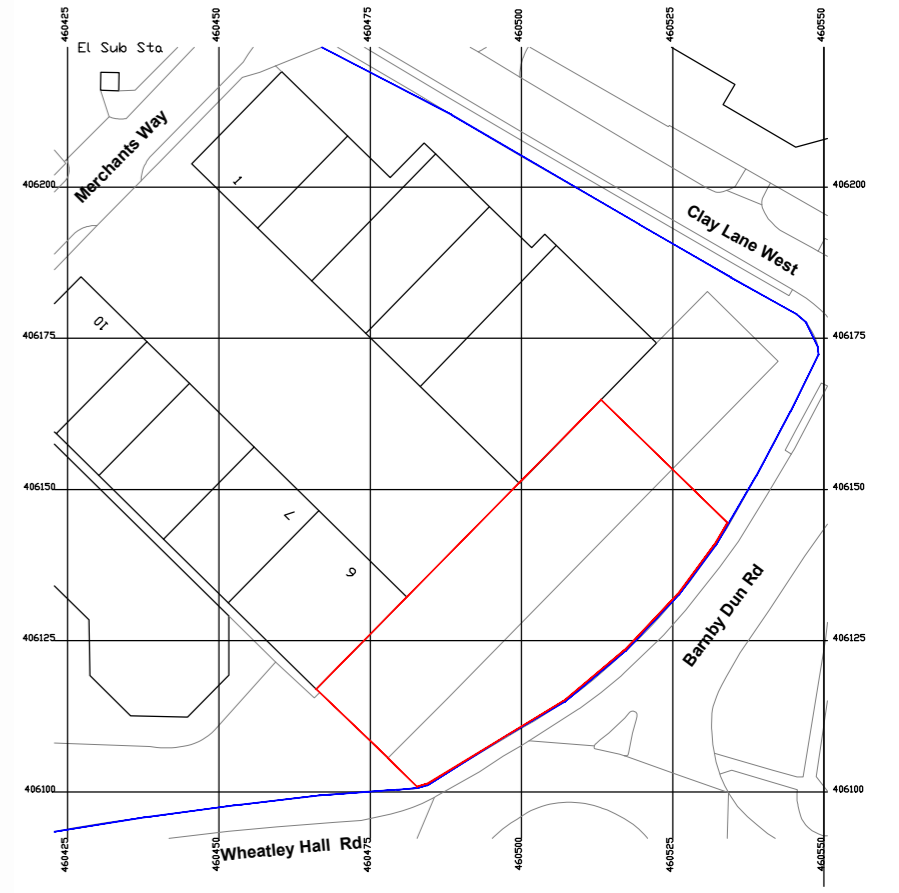

Site location plan - Scale 1:1250

Proposed site plan - Scale 1:200

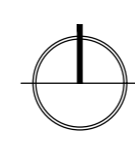

Ground Group Ltd, Wheatley Hall Road Trade & Business Centre, Doncaster

2017-ID-30-**PL003b**

PLANNING DRAWING

Date: 17th July 2018
 Proposed Site Plan_Layout
 Drawing scale Various @ A2



No 6 Whitehouse Way, Epworth, North Lincs
 M: 07917 224361 T: 01427 875012
 E: nwh@sleDesign-architecture.com
 CIAT Chartered Membership No: 015669



Proposed Ground Floor - General Arrangement

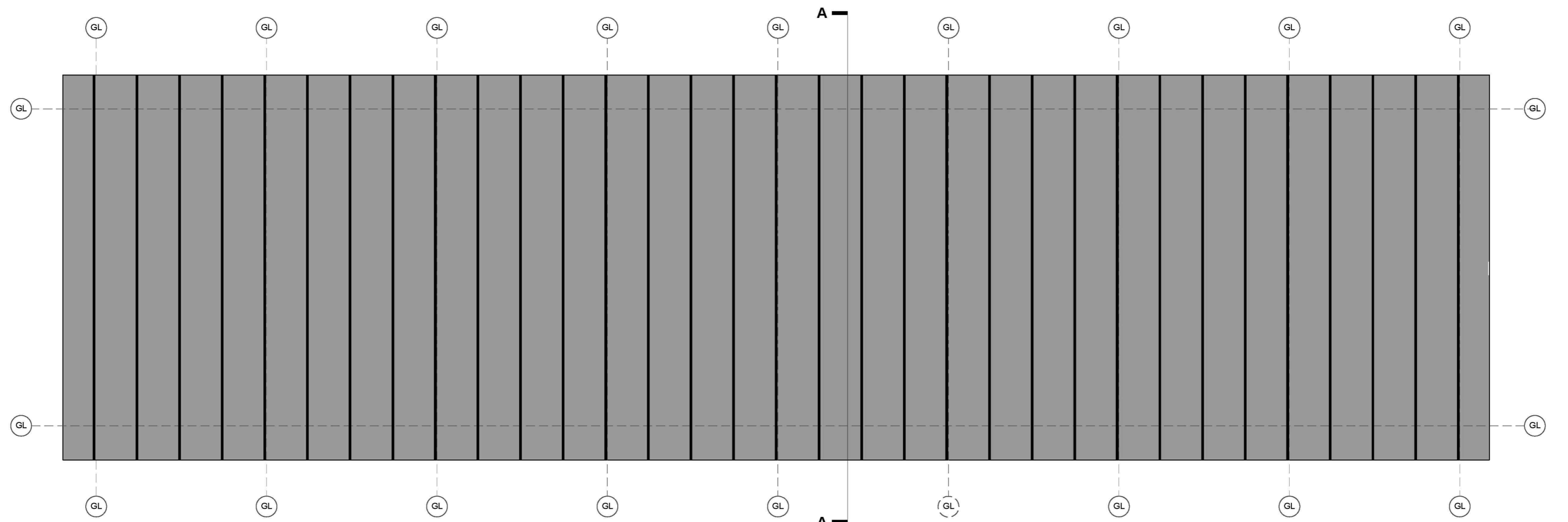

Proposed Roof - General Arrangement

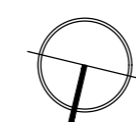

Date: 17th July 2018
 Proposed General Arrangements
 Drawing scale 1:100 @ A2
 Ground Group Ltd, Wheatley Hall Road Trade & Business Centre, Doncaster

2017-ID-30-**PL001b**

PLANNING DRAWING



No 6 Whitehouse Way, Epworth, North Lincs
 M: 07917 224361 T: 01427 875012
 E: nwh@sleDesign-architecture.com
 CIAT Chartered Membership No: 015669